

FOR SALE

# 7201 E 16TH STREET

KANSAS CITY, MO

AREA  
REAL ESTATE ADVISORS



## PROPERTY HIGHLIGHTS:

**BUILDING SIZE:** 11,993 SF

**ACREAGE:** 0.92 Acres with fenced lot

**POWER:** 3-Phase 400 Amps/480V with  
Power Converter

**CLEAR HEIGHT:** 15'

**COLUMN SPACING:** Clear Span

**LOADING:**

Drive-In (1) 16' x 12'

Dock High (2) 8' x 10'

**ZONING:** M1-5

**SINGLE TENANT NNN LEASE IN PLACE**

**SALE PRICE:** \$865,000



## MORE INFORMATION:

**GREG FOOTE**

**D** 816.876.2524

**E** GFOOTE@OPENAREA.COM

**AREA REAL ESTATE ADVISORS**

**A** 4800 MAIN ST, SUITE 400 • KANSAS CITY, MO 64112

**P** 816.895.4800 **W** OPENAREA.COM

The information used to create this brochure was gathered from sources deemed reliable. Though we do not doubt its accuracy, we do not guarantee or warranty it. You and your advisors should conduct a careful independent investigation of the information to determine your satisfaction and suitability.



# FLOOR PLAN & AERIAL VIEW

\*FLOOR PLAN NOT TO SCALE

**AREA**  
REAL ESTATE ADVISORS

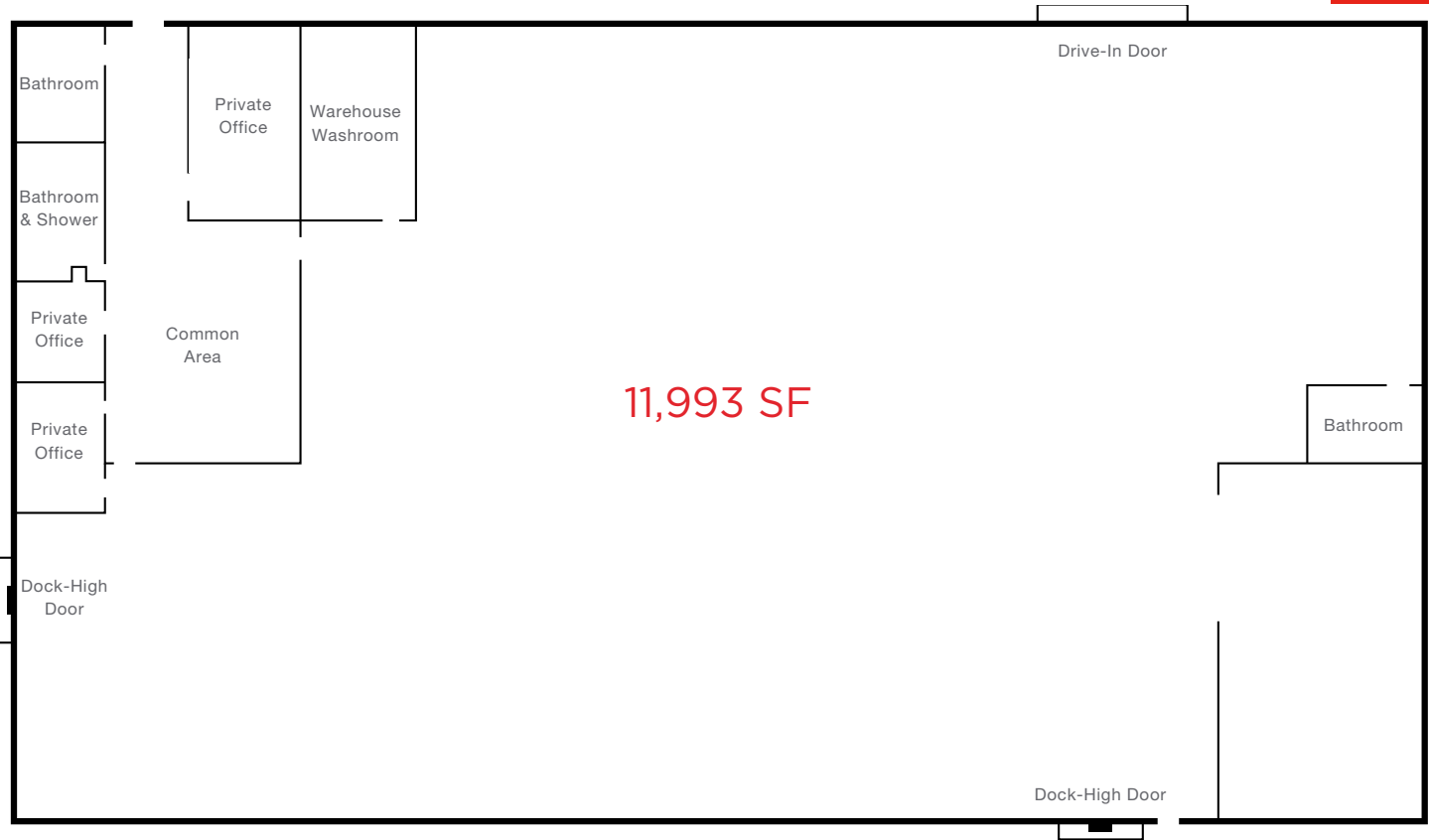

**AREA REAL ESTATE ADVISORS**

**A** 4800 MAIN ST, SUITE 400 • KANSAS CITY, MO 64112

**P** 816.895.4800 **W** [OPENAREA.COM](http://OPENAREA.COM)

The information used to create this brochure was gathered from sources deemed reliable. Though we do not doubt its accuracy, we do not guarantee or warranty it. You and your advisors should conduct a careful independent investigation of the information to determine your satisfaction and suitability.



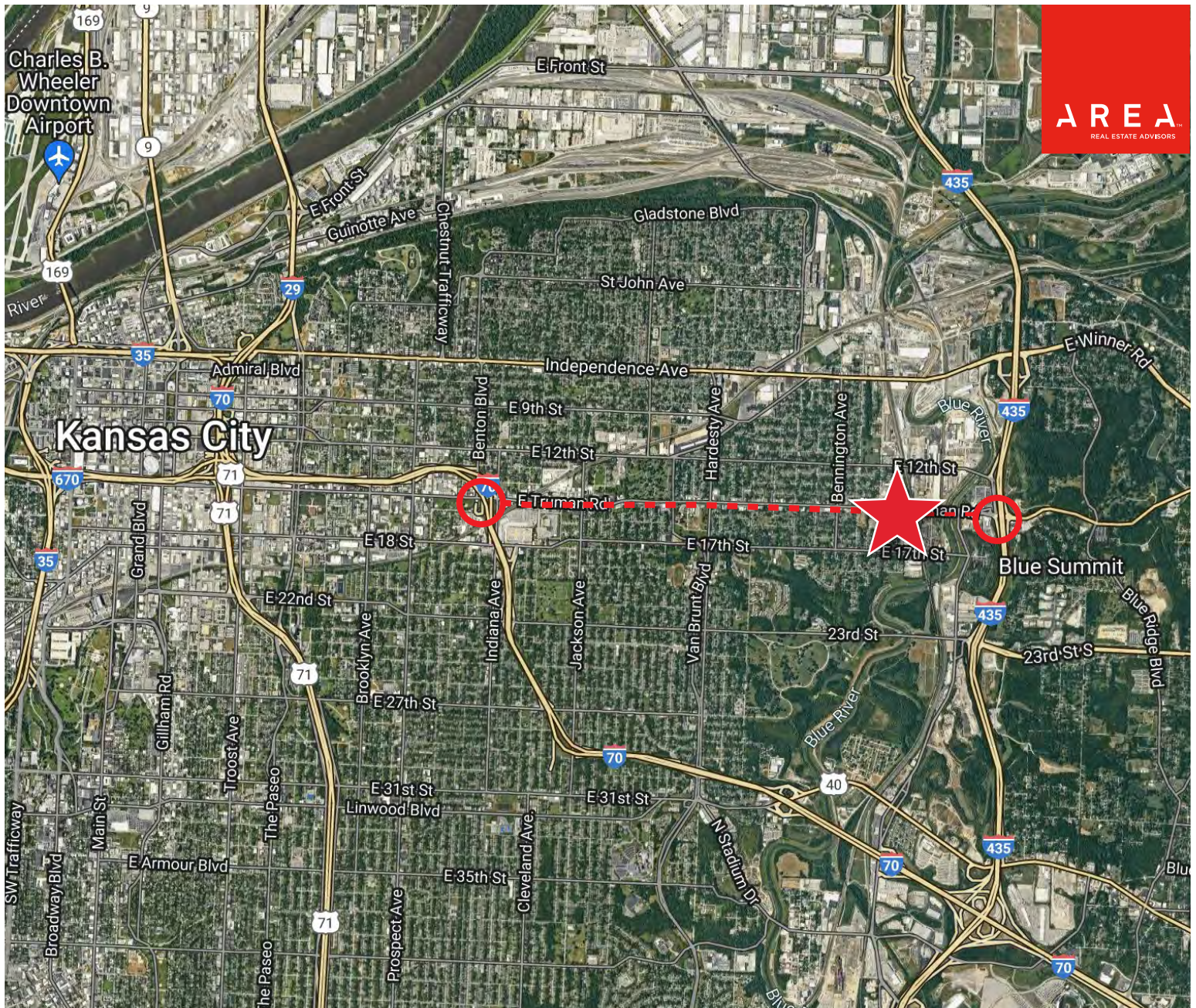

## HIGHWAY ACCESS:



I-435 - 3 MINUTES



I-70 - 6 MINUTES



71 HWY - 9 MINUTES



## AREA REAL ESTATE ADVISORS

**A** 4800 MAIN ST, SUITE 400 • KANSAS CITY, MO 64112

**P** 816.895.4800 **W** [OPENAREA.COM](http://OPENAREA.COM)

The information used to create this brochure was gathered from sources deemed reliable. Though we do not doubt its accuracy, we do not guarantee or warranty it. You and your advisors should conduct a careful independent investigation of the information to determine your satisfaction and suitability.